

Screeneguard™ SEMI-AUTO "T" SCREEN FILTERS

Installation, Operation & Maintenance Instructions



Netafim 2" and 3" Semi-Automatic plastic "T" screen filters are design to operate as both primary and secondary filter unit's dependent on the applications. The filters are available with multiple screen area and connection type to address any application needs. The filter body is made from durable plastic material for extra strength and longevity.

→ INSTALLATION

- Use Teflon tape on filter body inlet & outlet threads – do not use pipe dope
- Ensure correct water flow direction (as per arrow marking on filter)
- Flanged configuration includes anti rotation mechanism to allow installing at any required angle. When using flange - align filter position (angle) before tightening the bolts
- **DO NOT ROTATE FILTER AFTER BOLTS ARE IN PLACE**
- Assemble drain valve on the filter cover (O-ring included)
- Place rotation handle on the shaft, align holes and insert the plastic pin
- Ensure adequate space for operation and maintenance of the filter (See dimensional drawings)

→ ROUTINE INSPECTION

- The semi-automatic filter includes automatic clogging indicator (F)
- When pressure difference between filter inlet and outlet reaches 0.5 Bar, the red indicator (R) pops out and becomes visible
- This is an indication that the filter should be cleaned
- After cleaning, pressure difference returns to normal value, and the red indicator (R) retreats back automatically

→ SEMI-AUTOMATIC CLEANING OPERATION

- Open drain valve (D)
- Rotate handle (H) slowly all the way out and then back in
- **NOTE – while working with low quality water or low-pressure application, it is advised to perform the cleaning operation while the downstream valve is closed**
- Close drain valve (D)

→ DISMANTLING THE FILTER

- Turn off the water to the filter
- Open the drain valve (D) to release any remaining pressure
- Open filter body clamp (B) and remove filter cover (C) from filter body (A)
- Pull out screen elements (E) from filter body (A)

→ ASSEMBLY

- Ensure the screen element (E) is clean and that both O-rings are in place
- Rotate the suction mechanism clockwise all the way in
- Push screen element (E) into filter body (A)
- Place filter cover (C), make sure the suction pipe is inside the lower bushing
- Push the filter cover (C) to place
- Lock with filter body clamp (B) using the clamp lever
- Close drain valve (D)
- Open the water gradually, to avoid water hammers

→ CLEANING & MAINTENANCE

- Use pressure hose to thoroughly clean screen elements
- If needed use soft nylon brush to help with cleaning to screen
- Do not use any abrasive tools
- Inspect nozzle cleaning assembly and make sure all nozzles are intact

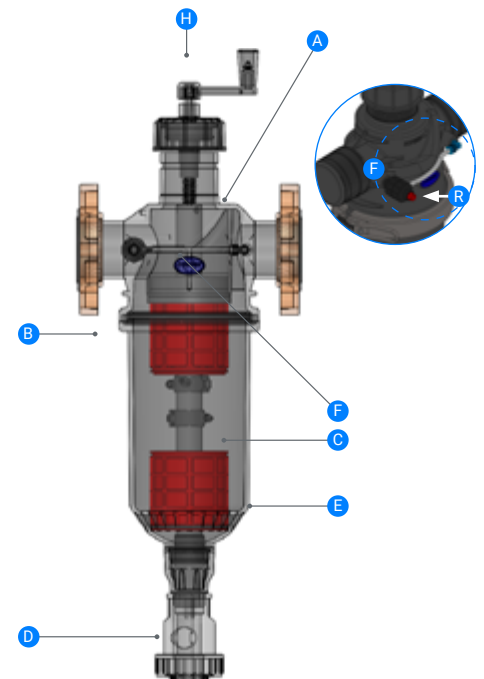

WARNINGS

Do not open the filter under pressure

During winter season, drain the filter to avoid freezing damage

Do not backflow water through the filter

→ TECHNICAL DATA

	2"		3"	
	REGULAR	JUMBO	REGULAR	JUMBO
MAX WORKING PRESSURE	8 BAR/115 PSI			
MAX RECOMMENDED FLOW*	20 M³/H	25 M³/H	25 M³/H	30 M³/H
FILTRATION SURFACE AREA	1,210 CM²	1,610 CM²	1,210 CM²	1,610 CM²
CONNECTION TYPES	BSP/NPT		BSP/NPT/UNF/VIC	
DRAIN VALVE DIAMETER	1.5"			

	A (MM)	B (MM)		C (MM)	D** (MM)	WEIGHT (KG)	
		THREADS /VIC	UNF			THREADS /VIC	UNF
2" REGULAR	980	335	-	670	420	6.5	-
2" JUMBO	1,100			790	540	7.5	-
3" REGULAR	980	340	-	670	420	6.5	7.5
3" JUMBO	1,100			790	540	7.5	8.5

* Maximum flow rate depends on water quality | Flange thickness - 35mm

** Distance required to open the filter

→ PART LIST

#	DESCRIPTION	2" REGULAR	2" JUMBO	3" REGULAR	3" JUMBO
1	FILTER BODY BSPT	71975-000100	71975-000100	71975-000114	71975-000114
	FILTER BODY NPT	71975-000120	71975-000120	71975-000121	71975-000121
	FILTER BODY FLANGED/BSPT	-	-	71975-000250	71975-000250
	FILTER BODY VIC/BSPT	-	-	71975-000251	71975-000251
2	FILTER COVER	71975-000401	71975-000402	71975-000401	71975-000402
3	FILTER CLAMP	71975-000480	71975-000480	71975-000480	71975-000480
4	FILTER COVER O-RING	71975-000260	71975-000260	71975-000260	71975-000260
4+5.1	FILTER MAIN O-RING KIT (PARTS 4, 5.1)	71975-000463	71975-000463	71975-000463	71975-000463
5	FINE SCREEN 100 MIC	71975-000383	71975-000386	71975-000383	71975-000386
	FINE SCREEN 130 MIC	71975-000384	71975-000387	71975-000384	71975-000387
	FINE SCREEN 200 MIC	71975-000385	71975-000388	71975-000385	71975-000388
6	COLLECTOR PIPE KIT FOR S.AUTO FILTER	71975-000490	71975-000491	71975-000490	71975-000491
6.1	NOZZLE KIT FOR S.AUTO FILTER	71975-000450	71975-000450	71975-000450	71975-000450
7	CLOGGING INDICATOR	71975-000560	71975-000560	71975-000560	71975-000560
8	FILTER DRAIN KIT	71975-000392	71975-000392	71975-000392	71975-000392
8.1	FILTER DRAIN VALVE	77450-000103	77450-000103	77450-000103	77450-000103
9	HANDLE KIT FOR S.AUTO FILTER	71975-000462	71975-000462	71975-000462	71975-000462
10	3" UNIVERSAL FLANGE KIT	-	-	71975-000440	71975-000440
11	FILTER HANDLE ACCESSORIES KIT BSPT	71975-000460	71975-000460	71975-000460	71975-000460
	FILTER HANDLE ACCESSORIES KIT NPT	71975-000461	71975-000461	71975-000461	71975-000461

→ TYPICAL INSTALLATION

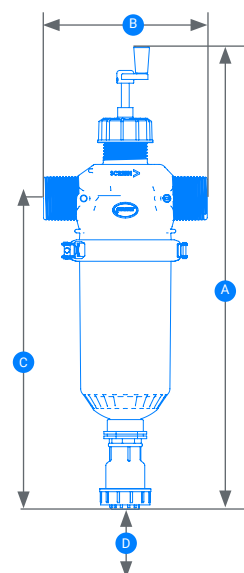
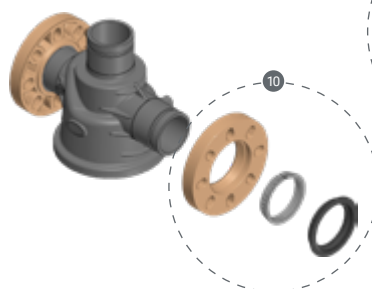
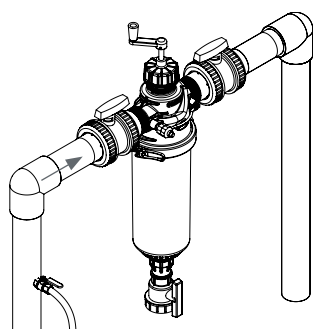

MESH	MICRON	COLOR
150	100	BLACK
120	130	RED
80	200	YELLOW

